

on balance  
as whole

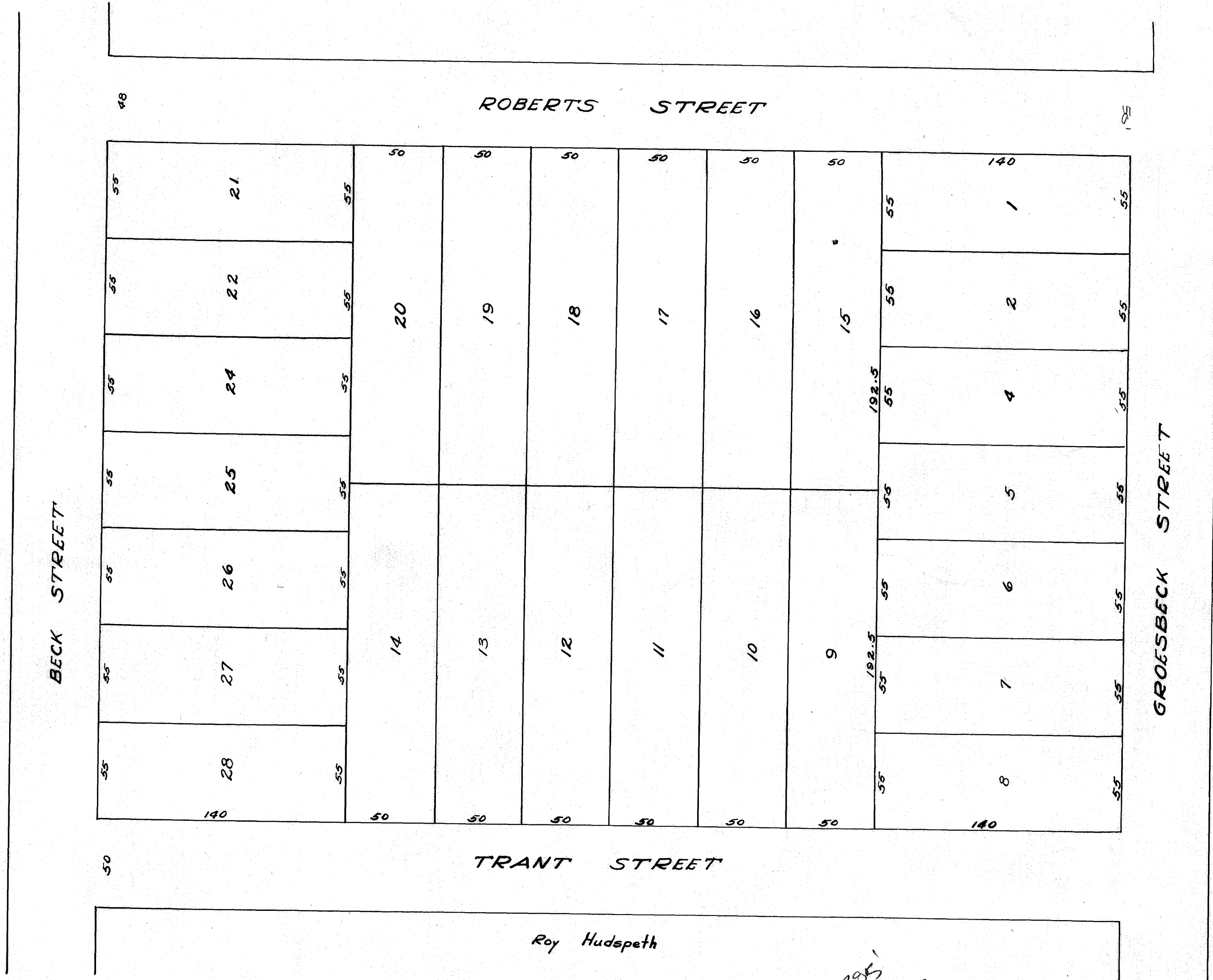

Roy Hudspeth

50' x 305'  
= 5,130 sq

ROBERTS ADDN.  
RE-SURVEY  
J.W. ENGLISH ESTATE  
A RESURVEY OF  
ROBERTS ADD'N  
TO THE CITY OF BRYAN  
D.R. 91 Pg. 477 6-17-'36  
SCALE: 1" = 50'

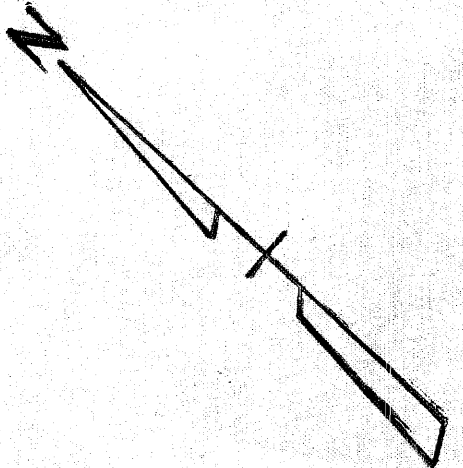

311